



A17251-C Series

Size: 172x151x55mm(6.77"x6"x2")

* Shaded Pole Motor Type Also Available.

DIMENSION

Unit:mm(inch)

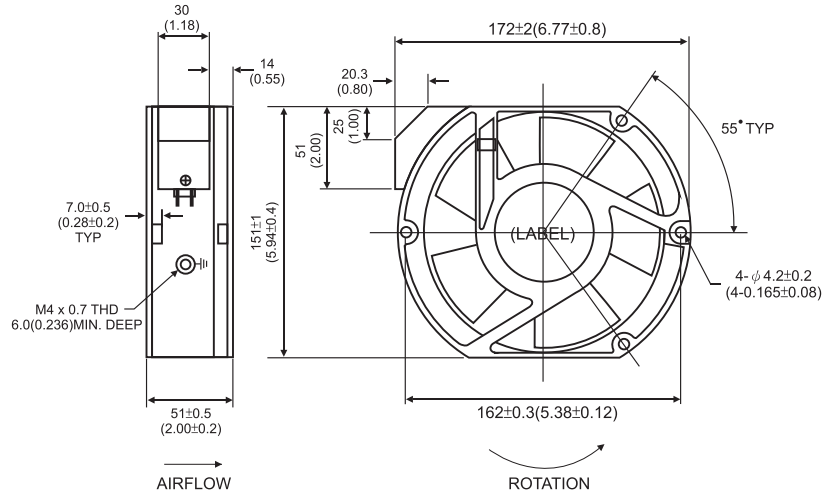

HOUSING : Die - Cast Aluminum, Painted Black
 IMPELLER : Thermoplastic PBT, UL94V - 0
 BEARING : Ball
 TERMINATION : Terminals
 MOTOR TYPE : Capacitor
 START VOLTAGE : 30 VAC for 115 VAC Type
 60 VAC for 230 VAC Type
 DIELECTRIC STRENGTH : 1,500 VAC for 1 minute
 INSULATION : Class B
 INSULATION RESISTANCE : 100,000 Ohms min. @500 VDC
 OPERATING TEMPERATURE : -20°C to + 80°C
 SAFETY : Thermally Protected (Auto Restart)
 WEIGHT : 875g (31 oz.)

AIR PERFORMANCE

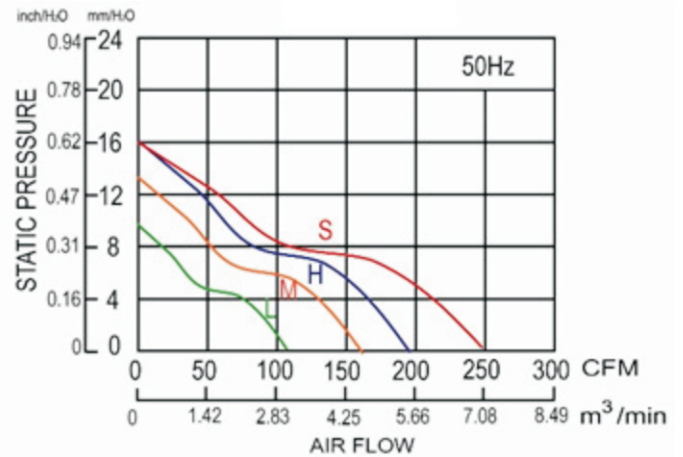
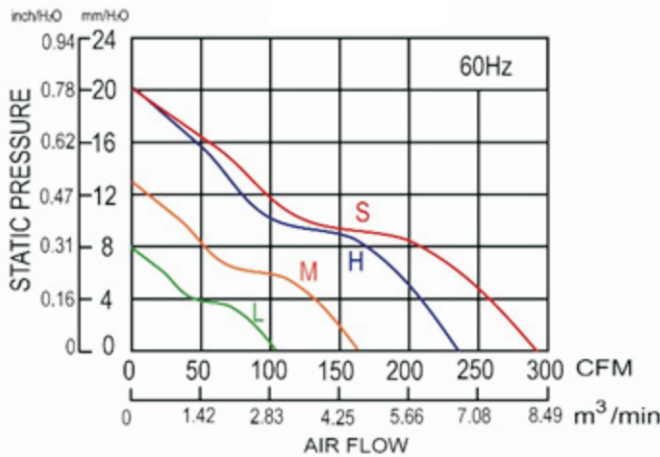

SPECIFICATION

MODEL NO.	RATED VOLTAGE (V)	FREQUENCY (Hz)	RATED CURRENT (A)	INPUT POWER (W)	SPEED (RPM)	AIR FLOW		NOISE dB(A) @ 1M
						CFM	m³/min	
A17251V1H	115	50 / 60	0.35/0.40	46/50	2850/3300	250/293	16.0/20.0	56/61
A17251V1M	115	50 / 60	0.23/0.30	32/31	2800/3100	190/235	15.0/19.0	50/45
A17251V1L	115	50 / 60	0.18/0.15	19.8/18.2	1450/1750	110/106	3.1/3.0	32
A17251V2H	230	50 / 60	0.20/0.22	46/50	2850/3300	250/293	16.0/20.0	56/61
A17251V2M	230	50 / 60	0.23/0.30	32/31	2800/3100	190/235	15.0/19.0	50/45
A17251V2L	230	50 / 60	0.08/0.07	17.9/17.1	1450/1750	110/106	3.1/3.0	32
A17251V1M-RD	115	50 / 60	0.23/0.25	26.7/29.7	2800/3200	190/235	5.4/6.6	50
A17251V2M-RD	230	50 / 60	0.11/0.13	26.7/31.2	2800/3200	190/235	5.4/6.6	50